

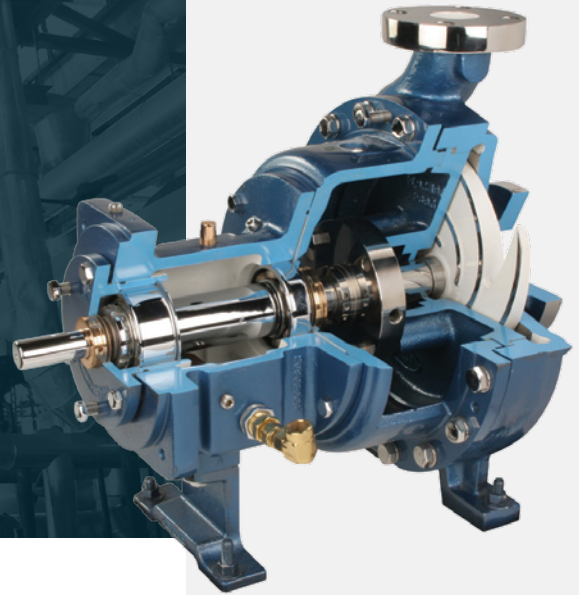

HEAVY-DUTY PROCESS ANSI B73.1 PUMP

Series 8196



The Peerless Pump PERFORMER™ Series Model 8196 ANSI standard pumps are manufactured for a wide range of flow and head requirements and meet the latest ASME and ANSI B73.1M specifications. The PERFORMER Series combines high efficiency, maximum performance, and extended mean time between failures (MTBF) for reduced maintenance cost.

FEATURES

The 8196 casing is a self-venting, top centerline discharge with a fully confined gasket. Class 150 lb. FF flanges are standard, with optional Class 150 lb. RF and both FF and RF Class 300 lb. flanges available. All ductile iron and 316SS casings are supplied with casing drains.

An optional Casing Wear Extender™ is available on 3x4-13 and 4x6-13 MTP frame sizes and on all XLTP frame sizes. The Wear Extender can be provided in wear-resistant materials, such as CD4MCu.

The impeller is a fully open design that significantly reduces clogging. Integral back pump-out vanes reduce stuffing box pressure, prolonging mechanical seal life. The impeller and casing are matched to achieve high efficiency and low NPSH. Sealed by an O-ring, the threaded area is protected against corrosion. All impellers are available in an optional keyed and bolted design.

A low-flow impeller is available for select sizes of STP frame pumps. This low-flow impeller helps extend MTBF for those applications operating far to the left of the best efficiency point (BEP) of the standard pump.

The power end has a bearing frame made of heavy-duty cast-iron (ductile iron on STP frame sizes) construction. It is designed with an enlarged oil reservoir for better dissipation of heat and bullseye sight glass for easy monitoring of oil levels. The bearing frame is coated internally to ensure zero contamination of the oil or bearings from inside.

The VBXD® labyrinth oil seal by Inpro, designed especially for Peerless Pump, provides both static and dynamic sealing using contact technology to positively seal the bearings from environmental contamination.

All bearing frames also include pre-drilled bosses for vibration-monitoring and / or temperature-monitoring devices.

Bearing fits are precision-bored, and all bearings meet or exceed the minimum ANSI L10 life of 17,500 hours.

The shaft is available with sleeve or in solid shaft construction.

All power ends are backed by a three-year warranty.

APPLICATIONS

- Corrosive, toxic and abrasive process liquids such as acids, bases and solvents
- Chemical and petrochemical
- Pulp and paper
- Plastics
- Refining
- Pharmaceutical

SPECIFICATIONS

| | |
|--------------------|-------------------------------------------|
| Capacities | Up to 4,500 gpm (1,022 m ³ /h) |
| Head | Up to 730 feet (222 meters) |
| Pressure | Up to 375 psi (2,586 kPa) |
| Horsepower | Up to 300 hp (224 kW) |
| Temperature | Up to 500°F (260°C) |
| Drives | Motors, engines, steam turbines |
| Liquids | Chemical, pulp and paper, all process |
| Materials | Ductile iron, 316SS, CD4MCuN |

8196 SERIES RANGE — 1750 RPM

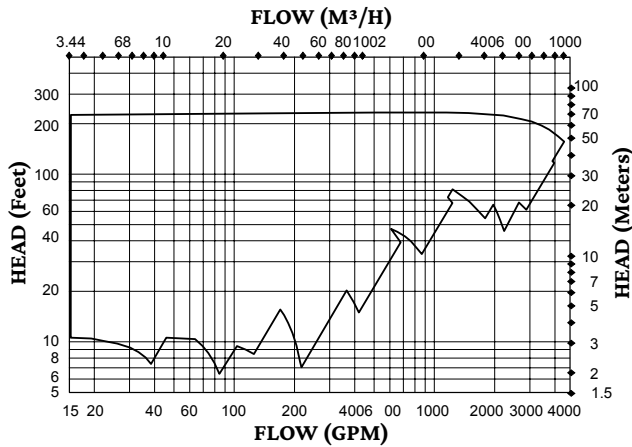

8196 SERIES RANGE — 3550 RPM

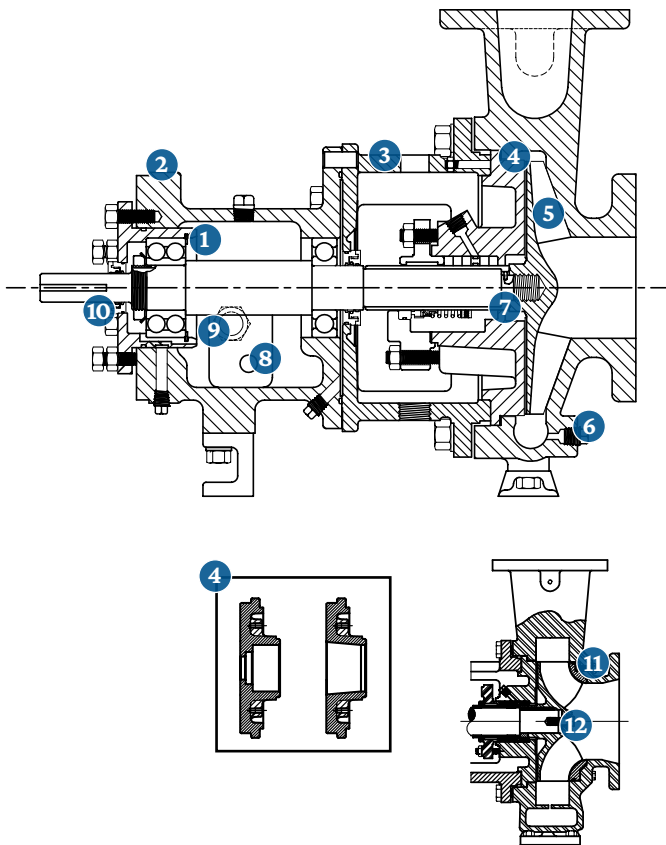
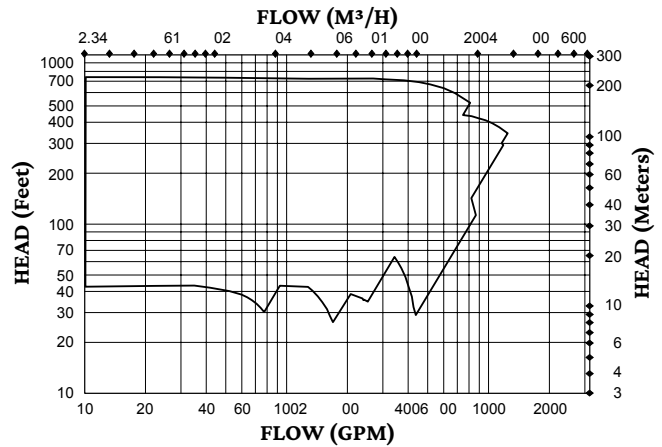

- 1 Coated Internal Bearing Frame**
- 2 Bosses**
For vibration-monitoring and / or temperature-monitoring devices.
- 3 Iron Frame Adapter**
Provides greater strength and durability.
- 4 Optional Seal Chambers**
Big bore and taper bore available for extra seal cooling.
- 5 Investment Cast Impeller**
Smooth finish for maximum efficiency.
- 6 Casing Drain**
Standard on iron and 316SS pumps; optional on other alloys.
- 7 Renewable Shaft Sleeve**
Positively driven, hook-type with a free end for expansion under varying temperatures.
- 8 Enlarged Oil Sump**
Improves heat transfer for more effective oil cooling.
- 9 Bullseye**
One-inch sight glass for easy, accurate monitoring of oil levels. Optional: Trico® Oiler.
- 10 Standard Inpro VBXD® Bearing Isolators**
Protect bearings from environmental contamination in both static and dynamic modes.
- 11 Wear Extender**
Optional for XLTP and some MTP sizes for reduced maintenance cost in abrasive applications.
- 12 Keyed and Bolted Impeller**
Optional on all sizes to prevent accidental loosening of impeller due to rotation.

Peerless Pump designs tough, versatile products to meet your pumping needs. The 8196 Series delivers variety, durability, standardized options and configurations unequalled in the industry.

For more information, contact your local authorized Peerless Pump distributor or visit peerlesspump.com



2005 DR. MARTIN LUTHER KING JR. ST.
INDIANAPOLIS, IN 46202

P 317.925.9661 F 317.924.7388 PEERLESSPUMP.COM

Flyer-042420
This flyer's contents subject to change without notice.
© Peerless Pump Company